

Project Brief

Sobrante WTP Clearwell Roof
Seismic Upgrade

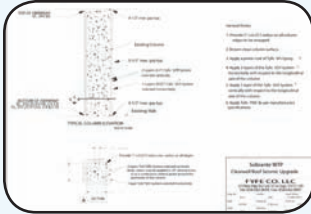

El Sobrante, CA, USA
 September 2002

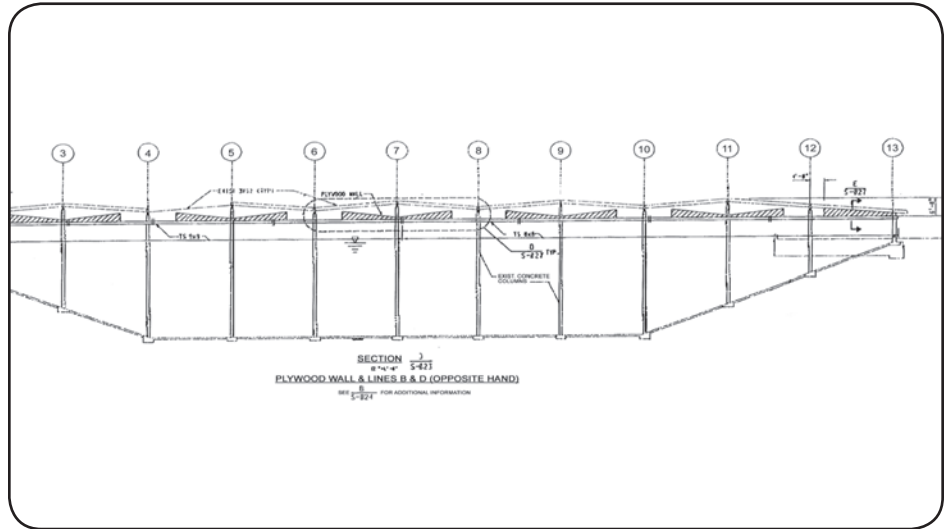

The El Sobrante WTP Clearwell was part of the East Bay Municipal Utilities District (EBMUD) 2000 Seismic Improvement Program. Located in El Sobrante just north of Berkeley, California the clearwell retrofit objectives were life safety and to ensure stability to the regional water system in a seismic event.

EBMUD had several columns supporting the El Sobrante Clearwell diaphragm that were deficient in flexural and confinement capacities.

Since the additional demands were relatively small in comparison to Tyfo® composites capacity, the most economical solution was the Tyfo® SEH System. Two (See file) layer of the composite was applied vertically to meet the tension requirement of 15 kips while another layer of the Tyfo® SEH System was applied transversely to provide the required confinement.

Fyfe Co. LLC

Nancy Ridge Technology Center

6310 Nancy Ridge Drive, Suite 103, San Diego, CA 92121-3209

Tel: 858.642.0694 **Fax:** 858.642.0947 **E-Mail:** info@fyfeco.com **www.fyfeco.com**